

Details about Your Aeration Basin & Clarifier No One Told You About

Credit Hours: 8 hours

Time: 8:00 AM to 5:00 PM

Location: Room C105, Claske Science and Engineering Building, LeTourneau University, Longview, TX

Glasko Engineering Center

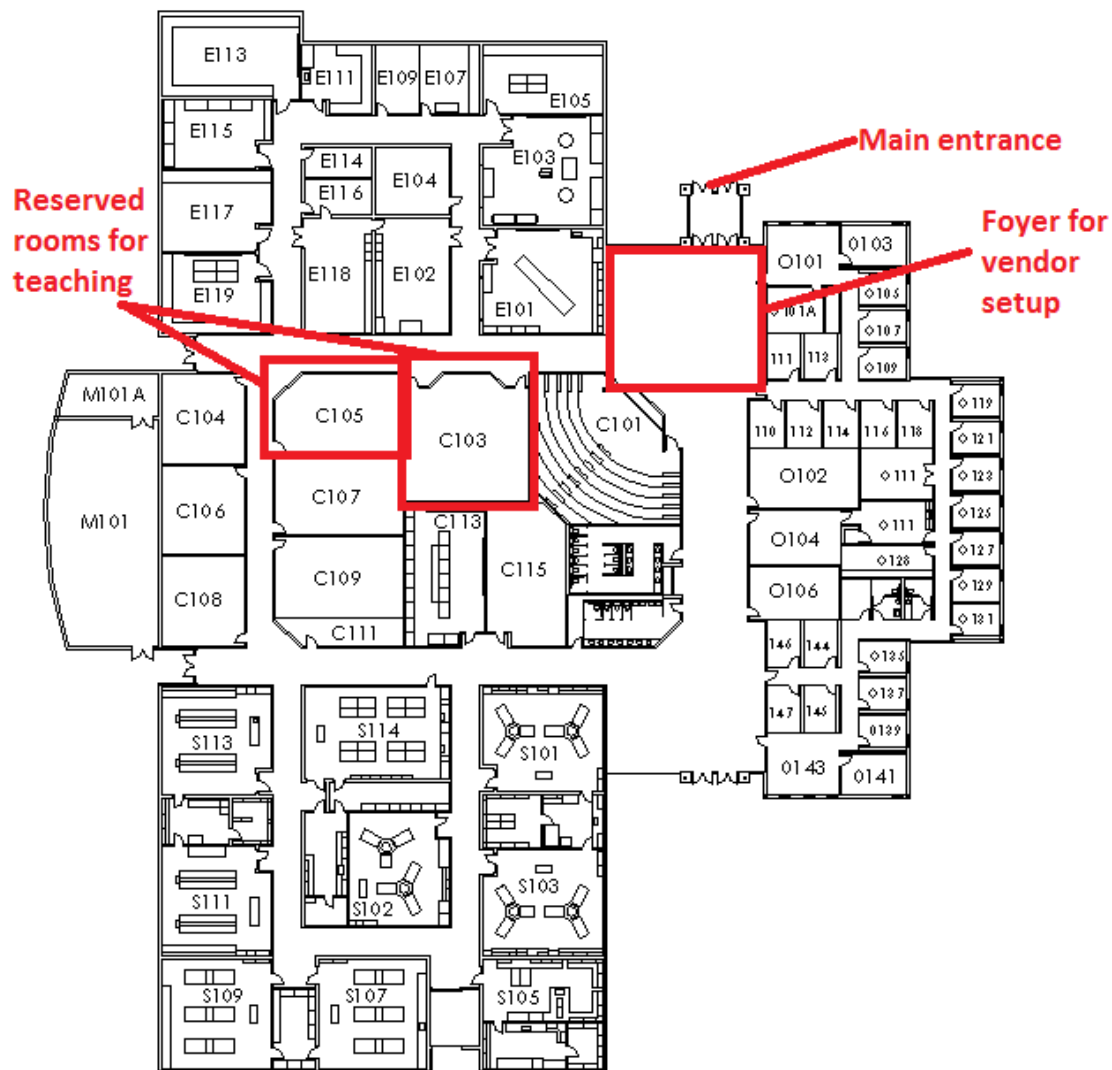



LETOURNEAU UNIVERSITY



1. Belcher Center



2. Longview Hall



3. Heath Hardwick Hall



4. Education Building



5. Estes Library



6. Memorial Student Center



7. Solheim Recreation Center



8. Glaske Science and Engineering Building

- 9. Student Life
- 10. Development / Alumni
- 11. Machine Tool / Design Lab
- 12. Civil Engineering
- 13. Engineering
- 14. Business Office
- 15. Corner Cafe
- 16. Materials Joining
- 17. Information Technology
- 18. University Police
- 19. Automotive Society
- 20. Facilities Services
- 21. Speer Chapel
- 22. South Hall
- 23. Gilbert Hall
- 24. Thomas Hall
- 25. Davis Hall

- 26. The Trinities
a. Maboo b. Pennsylvania c. LeTourneau
- 27. The Quads
a. Durham b. McKinley c. Howe d. Carpenter
- 28. Village Apartments
- 29. Married Housing
- 30. AO Society
- 31. KZX Society
- 32. LAS Society
- 33. Tyler Hall West
- 34. Tyler Hall East
- 35. Founders' Gravesites
- 36. Equipment Park
- 37. Belltower
- 38. Joyce Athletic Village
- 39. Allen Family Student Center



In addition to the facilities listed on this map, LeTourneau's Abbott Aviation Center is located a short, 7-mile drive from the campus at the East Texas Regional Airport.

Longview, Texas

About Longview: Just two hours east of Dallas, Texas • About an hour west of Shreveport, La.

- Serves as a central city for smaller, nearby towns
- Has a Metropolitan Statistical Area (MSA) of 150,000 in population
- Entertainment: movie theaters · great restaurants · mall · several shopping centers
- Culture: symphony · public library · museums · community theater · opera
- Major annual events, including the Great Texas Balloon Race and AlleyFest
- Over 100 places of worship
- Several area state parks for camping, hiking and picnicking
- Over 25 lakes within 75 miles
- Mild winters, with colorful springs and autumns
- Nice mix of rain and sunshine all year

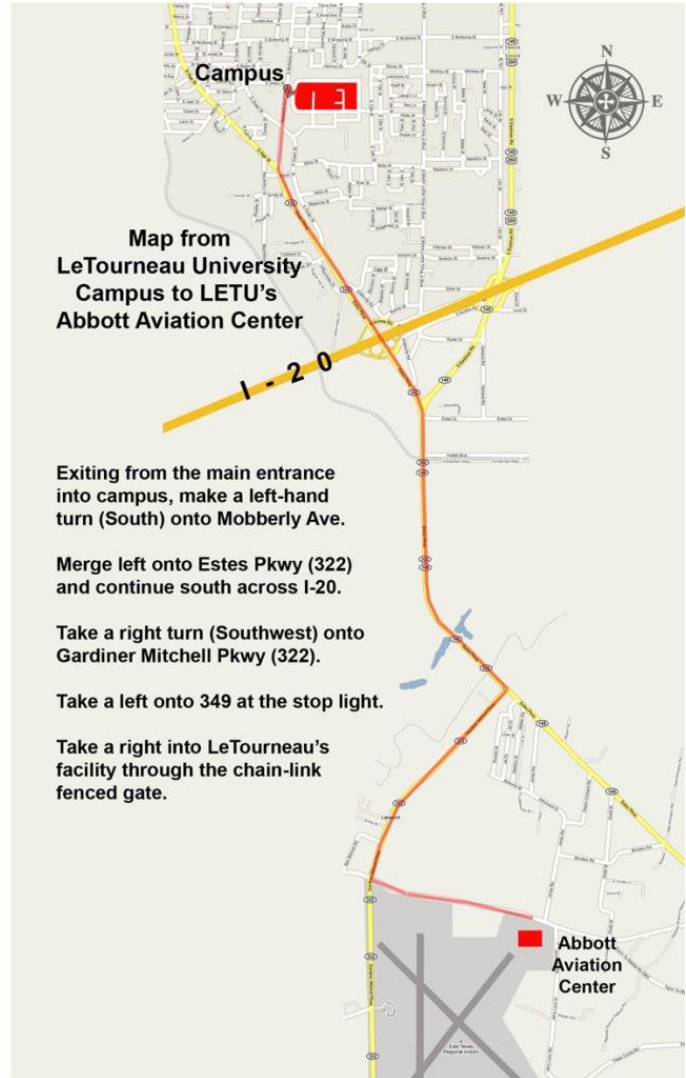

Map from
LeTourneau University
Campus to LETU's
Abbott Aviation Center

Exiting from the main entrance into campus, make a left-hand turn (South) onto Moberly Ave.

Merge left onto Estes Pkwy (322) and continue south across I-20.

Take a right turn (Southwest) onto Gardiner Mitchell Pkwy (322).

Take a left onto 349 at the stop light.

Take a right into LeTourneau's facility through the chain-link fenced gate.

Abbott
Aviation
Center